

# 'THE VERNON'

1,746 sq. ft

2 bedroom, 2 baths

## Features

- Executive kitchen with oversized island ideal for entertaining
- Large walk-thru pantry and functional mudroom
- Huge Master retreat, ensuite and walk-in closet
- Optional double sided fireplace into master retreat
- Choice of Tudor, French or Craftsman elevation



HARDER HOMES LTD.

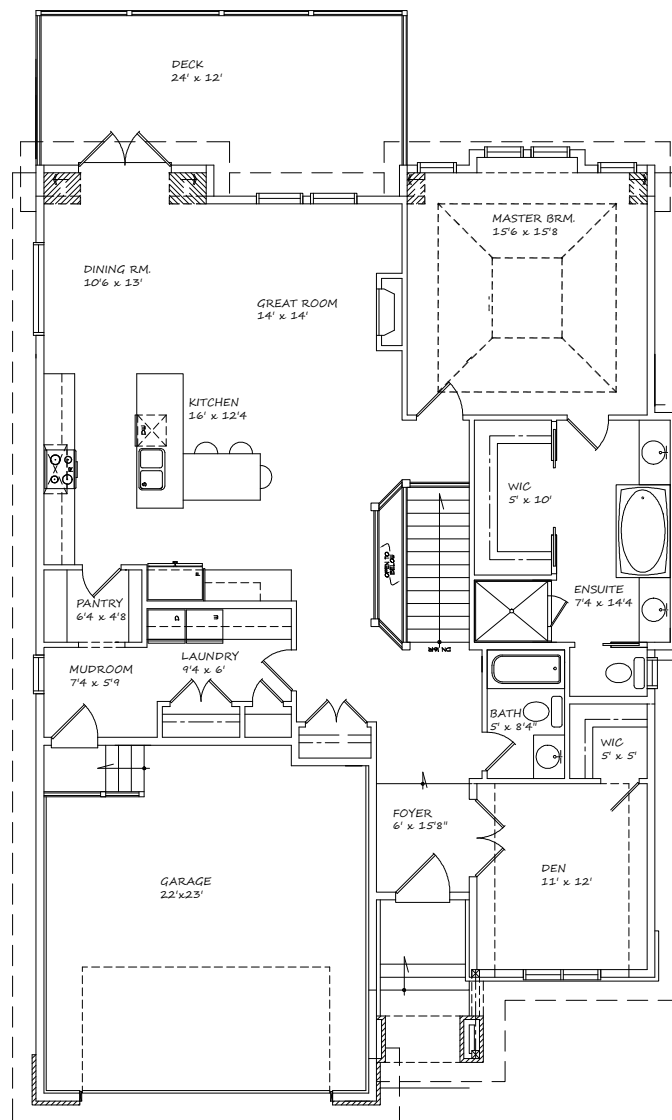

MAIN FLOOR  
1746 Sq.Ft

[WWW.HARDERHOMES.CA](http://WWW.HARDERHOMES.CA)

Harder Homes Ltd. | P.O. Box 10208 | Airdrie, Alberta | T4B 0H5 | 403-912-7900 | [sales@harderhomes.ca](mailto:sales@harderhomes.ca)

Copyright © 2013 Harder Homes Ltd. All rights Reserved